

DUBAI CREEK

HARBOUR

CREEK GATE



DUBAI CREEK HARBOUR فور دبي

CREEK GATE



PROPERTY SHOP
INVESTMENT LLC



LIVE
THE
HIGH
LIFE

CREEK GATE

A LIFE YOU HAVE DREAMED OF





PROPERTY SHOP
INVESTMENT LLC



A THRIVING WATERFRONT COMMUNITY



FIND YOURSELF
WHERE LIFE
HAPPENS











PROPERTY SHOP
INVESTMENT LLC



FLOOR PLANS

TOWER 1

CREEK GATE

DUBAI CREEK HARBOUR CREEK GATE

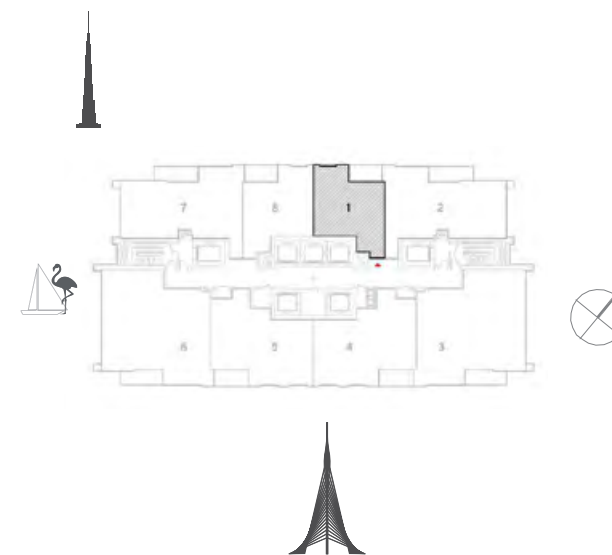

1 BEDROOM WITH BALCONY

TOWER 1
UNIT 1 | LEVELS 3-17, 19-30

Suite Area 645 Sq.ft. / 59.90 Sq.m.
Balcony Area 80 Sq.ft. / 7.42 Sq.m.
Total Area 725 Sq.ft. / 67.32 Sq.m.

DUBAI CREEK
HARBOUR
CREEK GATE



**2 BEDROOM
WITH BALCONY**

TOWER 1
UNIT 2 | LEVELS 3-17, 19-30

Suite Area 1018 Sq.ft. / 94.58 Sq.m.

Balcony Area 93 Sq.ft. / 8.60 Sq.m.

Total Area 1111 Sq.ft. / 103.18 Sq.m.

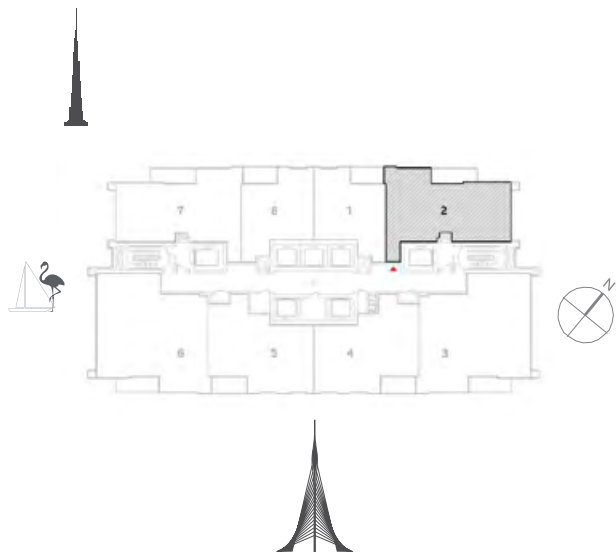

DUBAI CREEK
HARBOUR
CREEK GATE



**3 BEDROOM
WITH BALCONY**

TOWER 1
UNIT 3 | LEVELS 3-17, 19-30

Suite Area 1403 Sq.ft. / 130.31 Sq.m.

Balcony Area 87 Sq.ft. / 8.11 Sq.m.

Total Area 1490 Sq.ft. / 138.42 Sq.m.

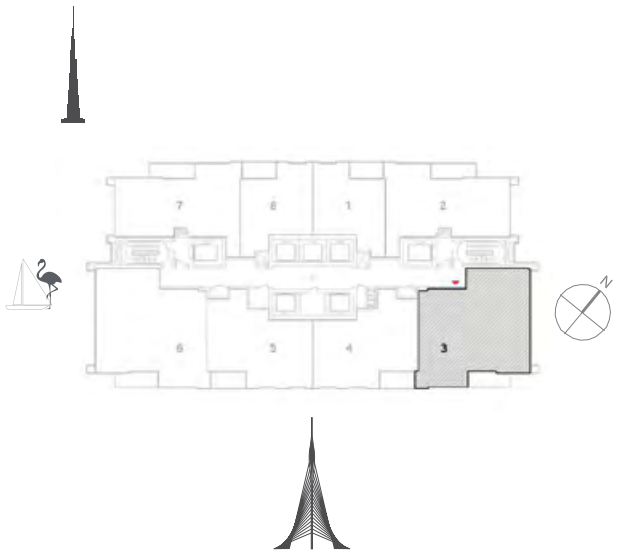

DUBAI CREEK
HARBOUR
CREEK GATE



**2 BEDROOM
WITH BALCONY**

TOWER 1
UNIT 4 | LEVELS 3-17, 19-30

Suite Area 963 Sq.ft. / 89.47 Sq.m.
Balcony Area 83 Sq.ft. / 7.68 Sq.m.
Total Area 1046 Sq.ft. / 97.15 Sq.m.

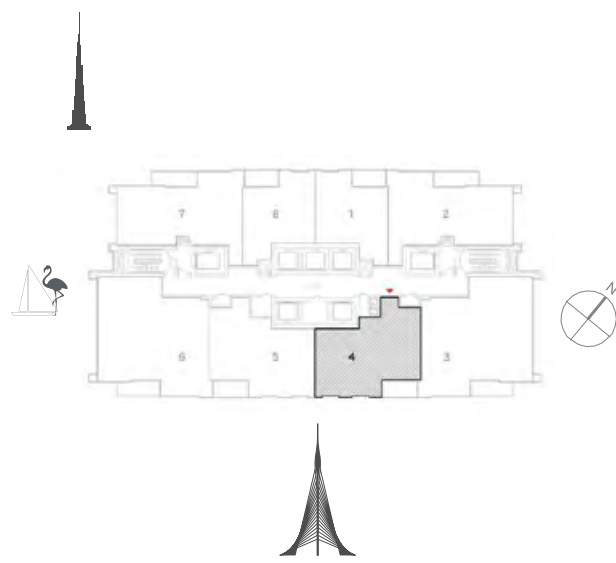

DUBAI CREEK
HARBOUR
CREEK GATE



**2 BEDROOM
WITH BALCONY**

TOWER 1
UNIT 5 | LEVELS 3-17, 19-30

Suite Area 963 Sq.ft. / 89.47 Sq.m.
Balcony Area 83 Sq.ft. / 7.68 Sq.m.
Total Area 1046 Sq.ft. / 97.15 Sq.m.

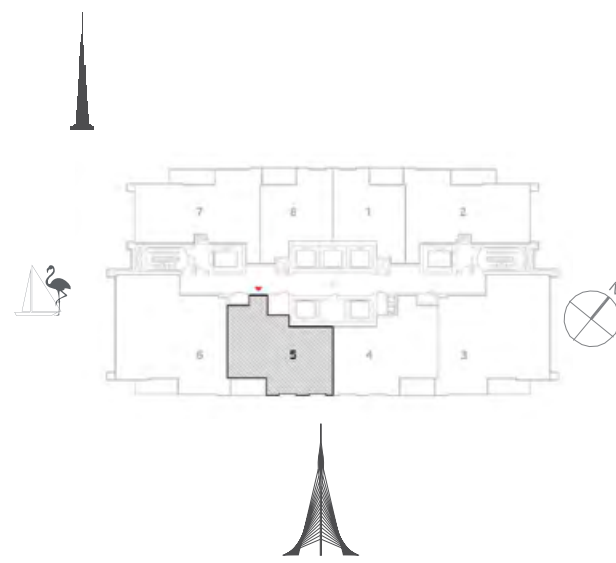

DUBAI CREEK
HARBOUR
CREEK GATE



3 BEDROOM
WITH BALCONY

TOWER 1
UNIT 6 | LEVELS 3-17, 19-30

Suite Area 1403 Sq.ft. / 130.31 Sq.m.
Balcony Area 87 Sq.ft. / 8.11 Sq.m.
Total Area 1490 Sq.ft. / 138.42 Sq.m.



DUBAI CREEK
HARBOUR
CREEK GATE



2 BEDROOM
WITH BALCONY

TOWER 1
UNIT 7 | LEVELS 3-17, 19-30

Suite Area 1018 Sq.ft. / 94.58 Sq.m.
Balcony Area 93 Sq.ft. / 8.60 Sq.m.
Total Area 1111 Sq.ft. / 103.18 Sq.m.



DUBAI CREEK
HARBOUR
CREEK GATE



1 BEDROOM
WITH BALCONY

TOWER 1
UNIT 8 | LEVELS 3-17, 19-30

Suite Area 645 Sq.ft. / 59.90 Sq.m.
Balcony Area 80 Sq.ft. / 7.42 Sq.m.
Total Area 725 Sq.ft. / 67.32 Sq.m.

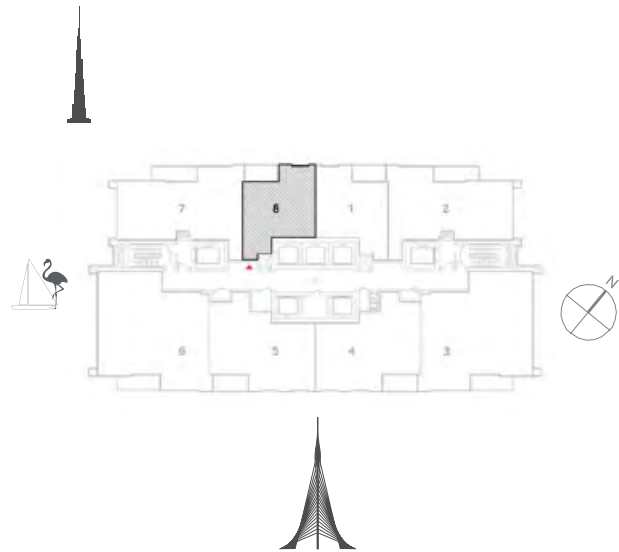



DUBAI CREEK HARBOUR

Payment Plan

<div>1st Installment</div> <div>5%</div> <div>Purchase Date</div>	<div>2nd Installment</div> <div>5%</div> <div>15 June 2017</div>	<div>3rd Installment</div> <div>10%</div> <div>15 Dec 2017</div>	<div>4th Installment</div> <div>10%</div> <div>15 Jun 2018</div>
<div>30% Construction Completion</div> <div>10%</div> <div>15 Dec 2018*</div>	<div>60% Construction Completion</div> <div>10%</div> <div>30 Jul 2019*</div>	<div>80% Construction Completion</div> <div>10%</div> <div>30 Dec 2019*</div>	<div>100% Construction Completion</div> <div>40%</div> <div>25 Aug 2020*</div>

* Estimated construction completion date



CONTACT DETAILS

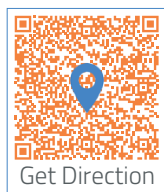

Head Office

Tel: 02 205 2999

Tel: 600 548 200

P.O.BOX 109537, Abu Dhabi, UAE

Abu Dhabi Al Muhairy Centre, M Level

Al Khalidiyah, Abu Dhabi, United Arab Emirates

www.propertyshopinvestment.com

info@psinv.net

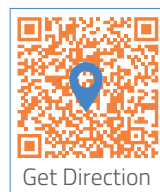

Al Reem Island Office

Amaya Tower, G Floor, Al Reem Island,
Shams Abu Dhabi, United Arab Emirates